

SCHILLERSTRASSE 45 · TREPPENHAUS 3 · STAIRWAY 3
3.02 STUDIO

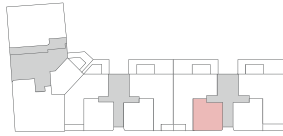

EG · 1-ZIMMER-STUDIO · GROUND · STUDIO WITH 1 ROOM

	m ²
WOHNEN, ESSEN, KOCHEN, SCHLAFEN / LIVING, DINNING, COOKING, SLEEPING	30,00
DIELE / HALLWAY	2,10
BAD / BATHROOM	4,90
GESAMTFLÄCHE / TOTAL AREA	37,00

