

SCHILLERSTRASSE 45 · TREPPENHAUS 3 · STAIRWAY 3

3.19 APARTMENT

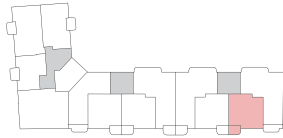

4. OG · 2-ZIMMER-WOHNUNG · 4TH FLOOR · APARTMENT WITH 2 ROOMS

	m ²
WOHNEN, ESSEN, KOCHEN / LIVING, DINNING, COOKING	21,90
SCHLAFEN / BEDROOM	12,90
ANKLEIDE / CLOSET	4,00
DIELE / HALLWAY	3,20
BAD / BATHROOM	5,80
WC / WC	2,00
SUMME / TOTAL	49,80
BALKON / BALCONY	5,20 2,60
GESAMTFLÄCHE / TOTAL AREA	52,40

